

# BOARD OF COUNTY COMMISSIONERS OF DOUGLAS COUNTY, KANSAS

## WEDNESDAY, MARCH 2, 2011

4:00 p.m.

-Convene

-Consider the approval of the minutes for December 22, 2010 and February 9, 2011.

## CONSENT AGENDA

- (1) (a) Consider approval of Commission Orders;
- (b) Consider approval to solicit bids for supply of asphaltic concrete (Keith Browning); and
- (c) Consider approval of Lone Star Lake Skiing Dates for 2011 (Keith Browning);
- (d) Consider authorization to renew pavement markings contract (Keith Browning)
- (e) Consider awarding contract for Bridge Replacement Project No. 2010-9 DGCO Bridge No. 15.89N-04.50E (Keith Browning)

## REGULAR AGENDA

- (2) Consider approval of new 911 phone system for Emergency Communications (Amanda Reusch)
- (3) Executive session to discuss possible property sale (Keith Browning)
- (4) Other Business
  - (a) Consider approval of Accounts Payable (if necessary)
  - (b) Appointments
  - (c) Miscellaneous
  - (d) Public Comment

## RECESS UNTIL 6:35 P.M.

Reconvene at 6:35 p.m.

- (5) Public Hearing date for Faye Coleman's petition for attachment of lands to Rural Water District No. 4 to be held at 6:35 p.m. (Scott Schultz)
- (6) Public Hearing having to do with a CDBG application for federal funding for a grant application submittal on Berry Plastics (Craig Weinaug)
- (7) Consider approval of Resolution with regard to funding of infrastructure improvements for Berry Plastics regarding (Craig Weinaug)
- (8) Adjourn

## TUESDAY, MARCH 8, 2011

-4:00-6:00 p.m. -Joint meeting at City Hall for City/County Study Session for discussion on the proposed Environmental Chapter to *Horizon 2020* and the Northeast Sector Plan.

## WEDNESDAY, MARCH 9, 2011

-Consider approval of Big Springs Consent Decree (6:35 p.m. contact Mary Miller)

-Presentation of the results of the County Sustainability Planning Process (Eileen Horn)

## WEDNESDAY, MARCH 16, 2011

No 4:00 p.m.

only 6:35 p.m.

-Consider request by Tenants to Homeowners for land at 25<sup>th</sup> and Cedarwood to create Active Senior Housing (Rebecca Buford)

**WEDNESDAY, MARCH 23, 2011-Light Agenda**

**MONDAY, APRIL 11, 2011**

9:00 a.m. Election Canvass

**WEDNESDAY, MAY 25, 2011 – Light Agenda**

**Note:** *The Douglas County Commission meets regularly on Wednesdays at 4:00 P.M. for administrative items and 6:35 P.M. for public items at the Douglas County Courthouse. Specific regular meeting dates that are not listed above have not been cancelled unless specifically noted on this schedule.*

## MEMORANDUM

To : Board of County Commissioners

From : Keith A. Browning, P.E., Director of Public Works/County Engineer

Date : February 23, 2011

Re : Consent Agenda Approval to Solicit Bids for Supply of Asphaltic Concrete

Public Works department requests BOCC approval to solicit bids for asphaltic concrete material supply for the 2011 maintenance season. Road & Bridge Fund 201 has \$482,500 allocated in the BM-2 line item.

As in the past, this year's supply contract will include a price adjustment factor tied to KDOT's Monthly Asphalt Price Index. The adjustment factor will increase/decrease the price for asphaltic concrete mix by \$0.50/ton for each \$10.00/ton increase/decrease in the Monthly Asphalt Price Index.

We plan to open bids in mid March. Contracts will be presented to the BOCC for approval thereafter.

Action Required: Consent Agenda approval to solicit bids for supply of asphaltic concrete mix for the 2011 maintenance season.

## MEMORANDUM

To : Board of County Commissioners

From : Keith A. Browning, P.E., Director of Public Works/County Engineer

Date : February 24, 2011

Re : Lone Star Lake Skiing Dates for 2011

Lone Star Lake regulations currently allow skiing from 12:00 noon to 8:00 p.m. on Wednesday through Sunday of each week between June 1 and Labor Day, and “on such other days as the (Board) approves”. The BOCC has additionally allowed skiing in September on Wednesday through Sunday of each week from 12:00 noon to 6:00 p.m. for the past two years. The extended September ski period has presented no problems.

We recommend continuing the same ski periods for 2011. Rather than revise the County Code and print new Rules & Regulations, it is recommended to add the September dates as “...other days as the (Board) approves”.

**In addition to allowing skiing from 12:00 noon until 8:00 p.m. on Wednesday through Sunday of each week between June 1 and Labor Day, this department recommends the BOCC allow skiing from 12:00 noon until 8:00 p.m. on the following date:**

**September 5 (Monday – Labor Day)**

**We also recommend the BOCC allow skiing from 12:00 noon until 6:00 p.m. on Wednesday through Sunday of each week between September 7 and September 25.**

Action Required: Approve skiing in 2011 at Lone Star Lake for the recommended dates and times.

## MEMORANDUM

To : Board of County Commissioners

From : Keith A. Browning, P.E., Director of Public Works/County Engineer

Date : February 24, 2011

Re : Consent Agenda authorization to renew pavement markings contract

This department contracts for supplying materials and painting pavement markings on county routes. Pavement markings typically need repainting annually. The BOCC executed a contract in 2007 for pavement marking services, and the contract is renewable for an additional four years (through 2011). Douglas County determines whether to renew the contract following the contractor's submittal of prices each year.

Our current contract is with Midwest Striping, Inc. from Grand Island, Nebraska. We have been extremely pleased with the quality of work and the responsiveness and cooperation from this contractor. This contractor provides excellent service at a reasonable cost.

Midwest Striping has submitted their prices for 2011 (see attached). The material cost for paint has increased \$0.27 per gallon. The application cost remains unchanged since 2008 at \$4.25/gallon. The unit costs for painted symbols have not increased since 2007. The attached spreadsheet shows 2011 quantities and bid prices versus 2010 quantities and prices. You will note the quantity of yellow paint has increased from 2010 to 2011. This is due to our revising no-passing zones to meet current standards.

The total bid amount for 2011 pavement marking is \$141,459.13. Road & Bridge Fund 201 has \$138,600 allocated for this work. The paint quantity increase noted above will cause a slight over-expenditure in this line item. Preferably, we will repaint all pavement markings this year. In an attempt to stay within budget, we will search for road sections for which the existing paint quality is such that we could skip painting this year. If possible, we will under-run the contract paint quantity to stay within budget.

I am also requesting authorization to approve change orders up to 5% of contract cost. The paint application rate will vary depending on pavement surface type and condition. Typically, our final costs are very close to the bid amount.

Action Required: Consent Agenda authorization for the Public Works Director to renew the contract with Midwest Striping, Inc. for 2011 pavement markings in the amount of \$141,459.13, and authorization for the Public Works Director to approve change orders totaling up to 5% over the contract amount.

**PROJECT NO. 2011-7**  
**RENEWAL BID #07005**  
**DOUGLAS COUNTY, KANSAS**  
**TYPE OF WORK: TRAFFIC MARKING**  
**ITEM: REVISED UNIT PRICES FOR 2011 MAINTENANCE SEASON**  
**DATE : FEBRUARY 23, 2011**

FOR INFORMATION ONLY

ITEM NO.	ITEM DESCRIPTION	UNIT	2011 QTY	2011 UNIT PRICE	2011 AMOUNT	2010 QTY	2010 UNIT PRICE	2010 AMOUNT
1	Application of Painting Materials (4") (White/Yellow)	Gal.	9,564	\$4.25	\$40,647.00	9,439	\$4.25	\$40,115.75
2	Material Cost (Paint) (Yellow)	Gal.	3,519	\$10.42	\$36,667.98	3,354	\$10.15	\$34,043.10
3	Material Cost (Paint) (White)	Gal.	6,045	\$10.42	\$62,988.90	6,085	\$10.15	\$61,762.75
4	Pavement Marking (Paint) (White) (24")	L.F.	288	\$0.20	\$57.60	222	\$0.20	\$44.40
5	Pavement Marking (Paint) (White) (18")	L.F.	84	\$0.15	\$12.60			\$0.00
6	Pavement Marking (Paint) (Yellow) (18")	L.F.	667	\$0.15	\$100.05	667	\$0.15	\$100.05
7	Pavement Marking Symbol (White) (Paint) (Turn Arrow, Lt-Rt.)	Ea.	52	\$10.00	\$520.00	46	\$10.00	\$460.00
8	Pavement Marking Symbol (Paint) (White) ("ONLY")	Ea.	4	\$15.00	\$60.00	8	\$15.00	\$120.00
9	Pavement Marking Symbol (Paint) (White) (RR Xing. Symbol)	Ea.	9	\$45.00	\$405.00	9	\$45.00	\$405.00

**GRAND TOTAL**

**\$141,459.13**

**\$137,051.05**

**MEMORANDUM**

To : Board of County Commissioners

From : Keith A. Browning, P.E., Director of Public Works/County Engineer

Date : February 24, 2011

Re : Consider Awarding Contract for Bridge Replacement Project No. 2010-9  
DGCO Bridge No. 15.89N-04.50E

Bids were opened February 21 for the referenced project. The project entails replacing the existing bridge carrying E 450 Road over a tributary to Deer Creek. The existing bridge is situated approximately 0.11 miles south of Route 442, and was constructed in 1920. It is a 28'-span steel beam span with a drainage area of approximately 2.4 square miles. The bridge is classified "structurally deficient", and is posted for a 5-ton maximum load.

We received bids from six contractors as shown below (also see attached bid tabulation). The low bidder was RD Johnson Excavating Co, Inc., of Lawrence.

<u>Low Bidder</u>	<u>Total Bid</u>
RD Johnson Excavating	\$169,999.00
King Const. Co.	\$186,659.00
Bryan-Ohlmeier Const. Co.	\$196,000.00
Freeman Concrete Const.	\$239,590.00
Midwest Const. Co.	\$252,368.80
Ebert Const. Co.	\$265,574.62
Engineer's Estimate	\$235,285.00

It is recommended to accept the low bid from RD Johnson Excavating Co., Inc. in the amount of \$169,999.00. I request authority to approve change orders totaling up to 10% of the base bid amount. The CIP allocates \$285,354 for total project costs.

Action Required: Accept the low base bid from RD Johnson Excavating Co., Inc. in the amount of \$169,999.00 for Project No. 2010-9, and authorize the Public Works Director to approve change orders up to 10% of the contract amount.



To: Douglas County Board of County Commissioners  
County Administrator Craig Weinaug

From: Amanda Reusch  
Interim Director  
Douglas County Emergency Communications

Date: February 25, 2011

Subject: New Phone System for Douglas County Emergency Communications

Attached is a bid from Commenco for a new phone system for the Douglas County Emergency Communications Center. Commenco has provided phone service to our back-up 911 Center, KU Public Safety since 1999. By accepting the bid from Commenco, we will have redundancy between both centers. Commenco is part of the state contract. The current phone system that we have installed is obsolete, very outdated, and costly to maintain. The current equipment we have installed is no longer being made, and is very difficult to repair. The new system will also be next generation 911 (NG911) compliant. All 911 centers nationwide will be required to be next generation compliant by January 1, 2013.

The bid for our new phone system is \$224,752.11. This amount includes premium maintenance for the second and third year (the first year warranty is covered by Commenco). We also need to purchase the point to point link, \$46,789.44 (cost includes second and third year maintenance), and the geo-diverse equipment, \$36,335.34 (cost includes second and third year maintenance.) The point to point link and the geo diverse equipment provide interoperability between the two centers. KU Public Safety is our back up public safety answering point. KU Public Safety will also be purchasing a new phone system from Commenco at the same time. Total cost of the phone project is \$431,371.01. Total cost paid out of the 911 fee fund-equipment reserve fund will be \$307,876.89. KU Public Safety cost will be \$123,494.12.

I have attached the proposed bid from Commenco. The bid includes the proposal on the new phone system for Douglas County Emergency Communications, the shared point to point link with KU Public Safety, as well as the geo-diverse resources that will be shared with KU Public Safety. The project summary is also attached to reflect the costs mentioned above.

Commenco also provided an overview of their business that I have attached as well.

The 911 advisory board is supportive of this system. The cost would be paid out of the 911 fee fund-equipment reserve account in our budget. There are sufficient funds in this line item to support this purchase.

If you have any questions, please feel free to contact me.

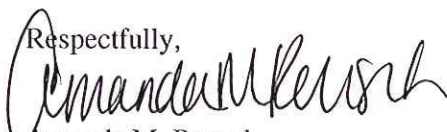
Respectfully,  
  
Amanda M. Reusch



# PROPOSAL

**Douglas Co Emergency Comm**  
**ATTN: Amanda Reusch**

111 E. 11th St., Suite 200  
 Lawrence, KS 66044-2909  
 Phone: 785-424-4115 (Cell)  
 Email: areusch@douglas-county.com



4901 Bristol Avenue., Kansas City, MO 64129  
 Voice (816) 753-2166 FAX (816) 753-3688

Item	Qty	Douglas County 911 System (Geo-Diverse w/KU Public Safety)	Prices	
			Unit	Extended
		<b>PlantCML Patriot 911 System - 6 Position System</b>		
		Geo-Diverse Shared with KU		
		Central Equipment for 9-1-1		
<b>1</b>		<b>Sentinel Patriot</b>		
1a	1	PAT 3.0 SYS SW DC L M	\$1,860.00	\$1,860.00
1b	1	PATRIOT SYS CFG	\$1,240.00	\$1,240.00
1c	1	PAT CAD INT LIC	\$620.00	\$620.00
1c	1	BLACK BOX TL160-R2	\$930.00	\$930.00
1c	1	DATA BROADCAST UNIT	\$436.48	\$436.48
<b>2</b>		<b>Server Equipment</b>		
2a	2	SVR Mini 2G Patriot	\$2,172.48	\$4,344.96
2b	1	SVR WIN2008 DGRD + 5CAL	\$1,003.16	\$1,003.16
2c	1	USB TO SERIAL HUB KIT	\$383.16	\$383.16
2d	0	PCI-C Card with 24 I/O	\$300.08	\$0.00
2e	1	MNTR, 17IN FP BK	\$271.56	\$271.56
2f	1	PAT PTS CERT OS	\$0.00	\$0.00
2g	2	PAT SVR CFG	\$620.00	\$1,240.00
<b>3</b>		<b>Peripherals &amp; Gateways</b>		
3a	1	PATRIOT ALARM PANEL	\$1,860.00	\$1,860.00
3b	1	PAT PERIPHERALS	\$3,100.00	\$3,100.00
3c	1	MODEM PACKAGE 56K EXT	\$778.72	\$778.72
3d	2	24-PORT 2610 PRCRVE SWTCH	\$652.24	\$1,304.48
3e	4	PAT FXO GATEWAY 8 PORT	\$1,635.56	\$6,542.24
3f	2	PAT FXS GATEWAY 4 PORT	\$894.04	\$1,788.08
3g	1	SECURITY FIREWALL 410 AP	\$2,868.12	\$2,868.12
3h	1	SECURE SPT 410 5YR	\$7,240.36	\$7,240.36
3i	1	VPN CONFIG SERVICE	\$248.00	\$248.00
3j	1	CONFIGURE NETWORK DEVICE	\$164.92	\$164.92
<b>Programming /Installation</b>			<b>Equipment Total</b>	
(Page 1 of 4)				
This proposal is considered Commenco Confidential Restricted. It is submitted with the restriction that it is to be used for evaluation purposes only, and is not to be disclosed publicly or in any manner to anyone other than those employed by either Douglas Co 911 or KU Public Safety required to evaluate this proposal without the express permission of Commenco, Inc.			<b>Extended Total</b>	
			<input type="text"/> <b>Sales Tax</b>	
			<b>NET TOTAL</b>	
<b>ACCEPTED BY</b>			<b>DATE</b>	

TERMS: NET 30/20% Restocking Fee on all cancelled orders    DELIVERY APPROX: TBD    DAYS A.R.O.  
 PRICES QUOTED ARE F.O.B. FACTORY    QUOTATION VALID FOR 60 DAYS  
 QUOTATION PREPARED BY: **Kris Evans 816-985-4030 (Cell)**    DATE: **1/20/11**

# PROPOSAL

Douglas Co Emergency Comm

ATTN: Amanda Reusch

111 E. 11th St., Suite 200

Lawrence, KS 66044-2909

Phone: 785-424-4115 (Cell)

Email: areusch@douglas-county.com



4901 Bristol Avenue., Kansas City, MO 64129

Voice (816) 753-2166 FAX (816) 753-3688

Item	Qty	Douglas County 911 System (Geo-Diverse w/KU Public Safety)	Prices	
			Unit	Extended
		<b>PlantCML Patriot 911 System - 6 Position System</b>		
		<b>Geo-Diverse Shared with KU</b>		
<b>4</b>		<b>Peripherals &amp; Equipment Racks</b>		
4a	1	EQPMT RACK 19 INCH	\$341.00	\$341.00
4b	1	KEYBOARD KVM 4 Port	\$548.08	\$548.08
4c	1	CBL KVM PS/2 CONSOLE	\$34.72	\$34.72
4d	4	CBL KVM PS/2 PC	\$69.44	\$277.76
4e	1	BRKT 19IN RACK MTG/ARBITR	\$39.68	\$39.68
4f	1	Installation Materials CE	\$1,975.00	\$1,975.00
4g	1	New Netlocks	\$6,523.00	\$6,523.00
		<b>Sentinel 9-1-1 Workstations</b>		
<b>5</b>		<b>Peripherals &amp; Equipment Racks</b>		
5a	6	WKSTN INTGR XP, HP	\$2,016.24	\$12,097.44
5b	6	PAT 3.0 PER SEAT LIC	\$6,820.00	\$40,920.00
5c	6	PAT 3.0 SW SPT 5YR	\$4,092.00	\$24,552.00
5d	0	PAT IRR LIC	\$1,233.80	Not Included
5e	0	PAT IRR SW SPT 5YR	\$740.28	Not Included
5f	6	PAT 3.0 SENT HARDWARE	\$1,984.00	\$11,904.00
5g	6	4-CHANNEL, PCI SOUND CARD	\$679.52	\$4,077.12
5h	6	22" LCD Touchscreen Monitors	\$865.12	\$5,190.74
5i	6	KEYPAD 24 KEY PS2/USB	\$122.76	\$736.56
5j	6	Installation Materials Position (Remote)	\$575.00	\$3,450.00
5k	6	SENT IWS CFG	\$248.00	\$1,488.00
5l	6	SENT STAGING FEE PP	\$372.00	\$2,232.00
		<b>Programming /Installation</b>	<b>Equipment Total</b>	
		(Page 2 of 4)		
This proposal is considered Commenco Confidential Restricted. It is submitted with the restriction that it is to be used for evaluation purposes only, and is not to be disclosed publicly or in any manner to anyone other than those employed by either Douglas Co 911 or KU Public Safety required to evaluate this proposal without the express permission of Commenco, Inc.			<b>Extended Total</b> <input type="text"/>	
			<b>Sales Tax</b> <input type="text"/>	
			<b>NET TOTAL</b> <input type="text"/>	
<b>ACCEPTED BY</b>		<b>DATE</b>		

TERMS: NET 30/20% Restocking Fee on all cancelled orders

DELIVERY APPROX:

TBD

DAYS A.R.O.

PRICES QUOTED ARE F.O.B. FACTORY

QUOTATION VALID FOR 60 DAYS

QUOTATION PREPARED BY:

Kris Evans 816-985-4030 (Cell)

DATE:

1/20/11



# PROPOSAL

Douglas Co Emergency Comm

ATTN: Amanda Reusch

111 E. 11th St., Suite 200  
 Lawrence, KS 66044-2909  
 Phone: 785-424-4115 (Cell)  
 Email: areusch@douglas-county.com



4901 Bristol Avenue., Kansas City, MO 64129  
 Voice (816) 753-2166 FAX (816) 753-3688

Item	Qty	Douglas County 911 System (Geo-Diverse w/KU Public Safety)	Prices	
			Unit	Extended
		<b>PlantCML Patriot 911 System - 6 Position System</b>		
		<b>Geo-Diverse Shared with KU</b>		
<b>8</b>		<b>Peripherals &amp; Equipment Racks</b>		
8a	0	RACK, EQUIP SERVER 19INCH	\$1,129.64	\$0.00
8b	0	24 PORT PATCH PANEL	\$195.92	\$0.00
8c	0	CBL PATCH 15FT	\$17.36	\$0.00
8d	0	Printer USB Color W/Cable	\$238.08	\$0.00
8e	0	FIELD ENG-PRIMARY PlantCML (Aurora)	\$124.00	\$0.00
<b>9</b>		<b>Polcom Phones (For Admin Office)</b>		
9a	5	<b>Polcom #550 Phones</b>	\$857.20	\$4,286.00
		- Admin Phone License		
		- Voice Mail License / Mailbox		
		- Install / Test / Per Phone		
9b	3	Miscellaneous Hardware (Per Phone)	\$75.00	\$225.00
<b>10</b>		<b>PREMIUM Advanced Hardware Suport 24X7 Response</b>		
10a	1	Premium Maintenance Year 2	\$17,598.66	\$17,598.66
10b	1	Premium Maintenance Year 3	\$18,478.59	\$18,478.59
10c	1	Premium Maintenance Year 4	\$19,402.52	Not Included
10d	1	Premium Maintenance Year 5	\$20,372.65	Not Included
<b>Programing /Training/Installation</b>			<b>Equipment Total</b>	\$210,535.91
<b>11</b>		<b>Training</b>		
11a	1	Commenco On-Site Training (1 Week) for Admin and Operators/Users	\$4,740.00	\$4,740.00
<b>12</b>	<b>6</b>	<b>PlantCML Loyalty Discount (2000.00 per postion)</b>	<b>(\$2,000.00)</b>	<b>(\$12,000.00)</b>
<b>13</b>	<b>1</b>	<b>LOT - Installation Services</b>	LOT	\$14,828.99
<b>14</b>	<b>1</b>	<b>LOT - Project Management Services</b>	LOT	\$3,489.17
<b>15</b>	<b>1</b>	<b>First Year Warranty/Service - 24/7 with 5 Hour Response</b>	LOT	No Charge
<b>16</b>	<b>1</b>	<b>Order Processing, Freight &amp; Insurance</b>	LOT	\$3,158.04
This proposal is considered Commenco Confidential Restricted. It is submitted with the restriction that it is to be used for evaluation purposes only, and is not to be disclosed publicly or in any manner to anyone other than those employed by either Douglas Co 911 or KU Public Safety required to evaluate this proposal without the express permission of Commenco, Inc.			<b>Extended Total</b>	\$224,752.11
			<b>Sales Tax</b>	
			<b>NET TOTAL</b>	<b>\$224,752.11</b>
<b>ACCEPTED BY</b>		<b>DATE</b>		

TERMS: NET 30/20% Restocking Fee on all cancelled orders      DELIVERY APPROX: TBD      DAYS A.R.O.  
 PRICES QUOTED ARE F.O.B. FACTORY      QUOTATION VALID FOR 60 DAYS  
 QUOTATION PREPARED BY: **Kris Evans 816-985-4030 (Cell)**      DATE: 1/20/11

# PROPOSAL

Douglas County 911  
 ATTN: Amanda Reusch  
 and  
 KU Public Safety Office  
 ATTN: Rhonda Birdsong



4901 Bristol Avenue., Kansas City, MO 64129  
 Voice (816) 753-2166 FAX (816) 753-3688

Item	Qty	Douglas County 911 & KU Public Safety (Shared Point-To-Point Links)	Prices	
			Unit	Extended
		<b>4.9 GHz Point To Point Links for Geo-Diverse System)</b>		
		<b>Work Description:</b> Provide Shared Infrastructure to include: Two (2) 4.9 Ghz Point To Point Links To Connect KU Public Safety Office and Douglas County 911 Centers. Two "Links" Required - Equipment To Be Located On Water Tower.		
1	2	Motorola 4.9 GHz, 5 Mhz Wireless Backhaul Link with Surge Protectors (Can Be Upgraded At Later Date If Needed) (1 Link from KU to Water Tower and 1 Link From Water Tower to Douglas Co 911 Center)	\$12,725.81	\$25,451.63
2	3	HP Procurve #2610 Switches; 24 Port	\$538.75	\$1,616.25
3	2	Installation Services (Per Hop)	\$4,687.50	\$9,375.00
4	1	LOT - Miscellaneous Wire, Connectors for Install (For Both Hops)	LOT	\$950.00
5	1	Spare, Motorola 4.9 GHz PTP600 End Link Only Note - This would be a "spare" unit. This is optional, but highly recommended by Commenco. (Included In Total Price)	\$6,444.56	\$6,444.56
6		Hardware Maintenance Support (Regular Business Hours) Note: 24/7 Service Not Available As We Cannot Climb Towers At Night		
6a	1	Maintenance Year 2	\$1,440.00	\$1,440.00
6b	1	Maintenance Year 3	\$1,512.00	\$1,512.00
6c	1	Maintenance Year 4	\$1,587.60	Not Included
6d	1	Maintenance Year 5	\$1,666.98	Not Included
<b>Programming /Installation</b>			<b>Equipment Total</b>	\$46,789.44
(See Above)				
This proposal is considered Commenco Confidential Restricted. It is submitted with the restriction that it is to be used for evaluation purposes only, and is not to be disclosed publicly or in any manner to anyone other than those employed by either Douglas Co 911 or KU Public Safety required to evaluate this proposal without the express permission of Commenco, Inc.			<b>Extended Total</b>	\$46,789.44
			<b>Sales Tax</b>	
			<b>NET TOTAL</b>	<b>\$46,789.44</b>
<b>ACCEPTED BY</b>		<b>DATE</b>		

TERMS: NET 30/20% Restocking Fee on all cancelled orders    DELIVERY APPROX: TBD    DAYS A.R.O.  
 PRICES QUOTED ARE F.O.B. FACTORY    QUOTATION VALID FOR 60 DAYS  
 QUOTATION PREPARED BY: **Kris Evans 816-985-4030 (Cell)**    DATE: **Rev 2/24/11**

# PROPOSAL

Douglas County 911  
 ATTN: Amanda Reusch  
 and  
 KU Public Safety Office  
 ATTN: Rhonda Birdsong



4901 Bristol Avenue., Kansas City, MO 64129  
 Voice (816) 753-2166 FAX (816) 753-3688

Item	Qty	Douglas County 911 & KU Public Safety (Shared Resources for Geo-Diverse System)	Prices	
			Unit	Extended
		<b>PlantCML Patriot 911 System - 9 Position System</b>		
		Geo-Diverse shared with KU		
		<b>Aurora Stats System</b>		
<b>1</b>		<b>Aurora - MIS System Licensing &amp; Support</b>		
1a	0	AURORA 1.1 L/D/M (Required for Enterprise)	\$2,480.00	\$0.00
1b	0	AURORA COLLECTION LIC	\$992.00	\$0.00
1c	0	AURORA SPT 5 YR	\$595.20	\$0.00
1d	0	AURORA USER LICENSE	\$930.00	\$0.00
1e	0	SQL 2008 SVR RUNTIME STD	\$76.88	\$0.00
1f	0	WKST HP Z200 (Optional Aurora stats PC)	\$2,016.24	\$0.00
1g	0	GENERIC WKSTN CONFIG FEE	\$310.00	\$0.00
<b>2</b>		<b>Aurora Server Equipment</b>		
2a	1	SVR WIN2008 DGRD + 5CAL	\$1,003.16	\$1,003.16
2b	1	SVR TOWER ML350 G6	\$2,852.00	\$2,852.00
2c	1	AURORA ADV RPT PKG LIC	\$4,340.00	\$4,340.00
2d	3	HARD DRIVE 146GB SAS 15K	\$677.04	\$2,031.12
2e	1	DVD-RW ML310G5/ML350/70G6	\$143.84	\$143.84
2f	1	SQL 2008 SVR RUNTIME STD	\$76.88	\$76.88
2g	1	PRESENT TENSE CLIENT	\$68.20	\$68.20
2h	1	MIS SVR CFG	\$620.00	\$620.00
<b>3</b>		<b>Peripherals &amp; Equipment Racks</b>		
3a	1	RACK, EQUIP SERVER 19INCH	\$1,129.64	\$1,129.64
3b	1	24 PORT PATCH PANEL	\$195.92	\$195.92
3c	1	CBL PATCH 15FT	\$17.36	\$17.36
3d	1	Printer USB Color W/Cable	\$124.00	\$124.00
3e	48	FIELD ENG-PRIMARY PlantCML (Aurora)	\$124.00	\$5,952.00
<b>Programming /Installation</b>			<b>Equipment Total</b>	
<b>(Page 1 of 2)</b>				
This proposal is considered Commenco Confidential Restricted. It is submitted with the restriction that it is to be used for evaluation purposes only, and is not to be disclosed publicly or in any manner to anyone other than those employed by either Douglas Co 911 or KU Public Safety required to evaluate this proposal without the express permission of Commenco, Inc.			<b>Extended Total</b>	
			<input type="text"/>	
			<b>Sales Tax</b>	
			<b>NET TOTAL</b>	
<b>ACCEPTED BY</b>			<b>DATE</b>	

TERMS: NET 30/20% Restocking Fee on all cancelled orders    DELIVERY APPROX: TBD    DAYS A.R.O.  
 PRICES QUOTED ARE F.O.B. FACTORY    QUOTATION VALID FOR 60 DAYS  
 QUOTATION PREPARED BY: **Kris Evans 816-985-4030 (Cell)**    DATE: **Rev 2/24/11**

# PROPOSAL

Douglas County 911

ATTN: Amanda Reusch

and

KU Public Safety Office

ATTN: Rhonda Birdsong



4901 Bristol Avenue., Kansas City, MO 64129

Voice (816) 753-2166 FAX (816) 753-3688

Item	Qty	Douglas County 911 & KU Public Safety (Shared Resources for Geo-Diverse System)	Prices	
			Unit	Extended
<b>PlantCML Patriot 911 System - 9 Position System</b>				
<b>4</b>		<b>Spare Equipment</b>		
4a	1	PAT FXO GATEWAY 8PORT	\$1,635.56	\$1,635.56
4b	1	PAT FXS GATEWAY 4 PORT	\$894.04	\$894.04
4c	1	SWITCH 24-PORT PRCRV 2610	\$652.24	\$652.24
4d	1	WKST HP Z200	\$2,016.24	\$2,016.24
4e	1	MNTR 19IN W/SPKRS BLK NEC	\$359.60	\$359.60
4f	1	EXTERNAL SPEAKERS	\$38.44	\$38.44
4g	1	4-CHANNEL, PCI SOUND CARD	\$679.52	\$679.52
4h	1	PAT 3.0 SENT HARDWARE	\$1,984.00	\$1,984.00
4i	1	KEYPAD 24 KEY PS2/USB	\$122.76	\$122.76
4j	1	GENERIC WKSTN CONFIG FEE	\$310.00	\$310.00
<b>5</b>		<b>Advanced Hardware Suport 24X7 Response</b>		
5a	1	Maintenance Year 2	\$1,899.14	<b>\$1,899.14</b>
5b	1	Maintenance Year 3	\$1,994.10	<b>\$1,994.10</b>
5c	1	Maintenance Year 4	\$2,093.80	<b>Not Included</b>
5d	1	Maintenance Year 5	\$2,198.49	<b>Not Included</b>
<b>(Page 2 of 2)</b>				
<b>Programming /Training/Installation</b>			<b>Equipment Total</b>	<b>\$31,139.76</b>
<b>6</b>		<b>Training (Aurora)</b>		
6a	1	Commenco On-Site Training for Admin	\$1,926.00	\$1,926.00
<b>7</b>	<b>1</b>	<b>LOT - Installation Services</b>	LOT	\$2,315.95
<b>8</b>	<b>1</b>	<b>LOT - Project Management Services</b>	LOT	\$544.93
<b>9</b>	<b>1</b>	<b>First Year Warranty/Service - 24/7 with 5 Hour Response</b>	LOT	No Charge
<b>10</b>	<b>1</b>	<b>Order Processing, Freight &amp; Insurance</b>	LOT	\$408.70
<p>This proposal is considered Commenco Confidential Restricted. It is submitted with the restriction that it is to be used for evaluation purposes only, and is not to be disclosed publicly or in any manner to anyone other than those employed by either Douglas Co 911 or KU Public Safety required to evaluate this proposal without the express permission of Commenco, Inc.</p>			<b>Extended Total</b>	<b>\$36,335.34</b>
			<b>Sales Tax</b>	
			<b>NET TOTAL</b>	<b>\$36,335.34</b>
<b>ACCEPTED BY</b>			<b>DATE</b>	

TERMS: NET 30/20% Restocking Fee on all cancelled orders

DELIVERY APPROX:

TBD

DAYS A.R.O.

PRICES QUOTED ARE F.O.B. FACTORY

QUOTATION VALID FOR 60 DAYS

QUOTATION PREPARED BY:

**Kris Evans 816-985-4030 (Cell)**

DATE:

Rev 2/24/11

**PROJECT SUMMARY**  
**24-Feb-11**

<u>PlantCML 911 System</u>	<u>GEO-DIVERSE</u>	<u>GEO-DIVERSE EQUIP</u>	<u>POINT TO POINT</u>	<u>TOTAL GEO-DIVERSE</u>
KU Public Safety	\$123,494.12			\$123,494.12
Douglas County 911	\$224,752.11	\$36,335.34	\$46,789.44	\$307,876.89
<b>TOTAL</b>				<b>\$431,371.01</b>

**Notes:**

- 1) KU Public Safety "Geo-Diverse" Shown Above "DOES NOT INCLUDE" Extended Maintenance Costs.
- 2) Douglas County 911 "Geo-Diverse" Cost Shown Above "INCLUDES" Years 2 and 3 Premium Maintenance Costs.
- 3) Geo-Diverse and Point-To-Point Equipment "INCLUDES" Years 2 and 3 Standard Maintenance.





4901 Bristol Avenue, Kansas City, MO 64129 Office: 816-753-2166

**Douglas County 911 & KU Public Safety**

***Payment Terms for All Equipment  
(Same Terms As Used On MARC Contract)***

- 80% of Equipment / Shipping on receipt of equipment at Commenco
- 15% Equipment / 95% of Installation upon install completion
- Remaining 5% upon system acceptance
- Net 30 Days after final acceptance by customer



## Commenco

Commenco has been serving the western Missouri and eastern Kansas area continuously for three generations of same-family ownership. The company was started in 1951 and employs nearly 50 sales, service and administrative personnel at two locations. The main shop and offices are located at 4901 Bristol Avenue, Kansas City, Missouri, with another other shop in Kansas City, Kansas.

### Overview

Commenco provides communications solutions to government, industrial and commercial customers covering a broad combination of equipment and services.



Commenco offers a complete lineup of products and services that range from traditional two-way radios to Internet-based telecommunications systems. Commenco is a Motorola Premier Service Partner and a leading Motorola Dealer.

Some of the governmental accounts in the metropolitan area which rely upon Commenco for twenty-four hour service and support include Belton, Blue Springs, Clay County Missouri, Gladstone, Grandview, Independence, Jackson County Missouri, Johnson County Kansas, Kansas City Kansas/Wyandotte County Kansas, the Mid-America Regional Council (MARC), Olathe, and Raytown. Commercial customers include the Ameristar and Argosy Casinos, Bayer, General Motors, Ford, Harley Davidson, the Kansas City Chiefs, the Kansas City Royals, Nebraska Furniture Mart, Proctor & Gamble, and many other users of telecommunications equipment in the metropolitan area.

Commenco employs bench and field service technicians who are highly trained with an average experience level of over fifteen years per person. Field services are provided from service vehicles equipped with parts

inventories and test equipment. An experienced installation crew performs mobile and fixed equipment installations including towers and antennas. All technicians have at their disposal the latest test equipment and are supported by an extensive inventory.

Commenco's staff includes engineering and project management resources whose job is to provide project planning, scheduling and control. These people are trained in the latest technologies and employ industry recognized methods of system design and project administration. In addition Commenco employs a competent staff of support personnel to handle the day to day business needs.

Commenco also maintains a staff of inside and outside sales representatives who are trained and knowledgeable about the features of the many products that are offered. The years of experience and technical support enables them to provide first class sales and service to our many customers.

### **Commenco Strengths and Portfolio**

Commenco, Inc. is in the business of sales, installation, and maintenance of wireless communications and 9-1-1 equipment, and is the largest company in the industry in western Missouri and eastern Kansas. As the authorized Motorola facility for sales and service in the metropolitan area, Commenco has a customer base of governmental entities, manufacturers and commercial enterprises. Commenco's expertise covers radio equipment, 9-1-1 equipment, wireless infrastructure and dispatch console equipment.

Commenco is a winner of the Motorola Pinnacle Club award for sales and customer service in 4 of the past 6 years. Only the top facilities across the country receive this award from Motorola each year.

As a Premier Service Partner of Motorola, Commenco has installed major infrastructure projects for Motorola in Independence Missouri, Joplin Missouri, Omaha Nebraska, Wichita Kansas, Johnson County Kansas and Kansas City Kansas. In response to an RFP from the Mid-America Regional Council, Commenco was selected over telephone companies and 9-1-1 equipment manufacturers to provide a 9-1-1 system covering nine counties and 43 public safety answering points (PSAP). Since that original installation, Commenco, working closely with CML Emergency Services (now PlantCML) and GeoComm, developed, supplied, installed, and now maintains a digital network that connects redundantly the entire MARC 9-1-1 system to the first two wireless routers outside of a telephone company in the country.

Commenco's core competency lies in the field of two-way radio. For decades the two-way radio has been the solution of choice for all types of business. Two-way continues to be the quickest and most efficient mode of communication between two people or groups of 100's. Commenco offers a family of wireless broadband solutions that provide higher throughput than T1, ISDN, DSL, MMDS, cable or satellite. Easy installation and flexibility make this solution perfect for schools, campuses and multiple- intranet sites.

For today's increased need for security, the closed circuit TV is a solution that can save lives. These systems can be as simple as a single camera and monitor or as complex as being tied into wireless broadband networks. CCTV is ideal for restaurants, equipment lots, apartment complexes, warehouses or any place that needs visual monitoring. Commenco has the product, service and expertise to help make your property more secure.

## **Project Management**

Over the past two decades, radio systems have become more complex and sophisticated. Radio systems are no longer only voice communications networks, but also provide a medium for information of all types covering a variety of new and emerging applications. As system complexity increases, design, installation and integration become a more critical part of the total system. The skills required to perform these tasks have become more specialized.

Recognizing these changing requirements, Commenco has organized their resources to provide technical services divided into the following areas:

- System Engineering
- System Implementation
- Service and Maintenance
- Training

## **Support**

With the largest force of technical support experts of any radio system vendor in western Missouri or Kansas, customers can work closely with Commenco to guide the system design process to ensure the system meets the customer's requirements. The pre-sale support ensures that the most effective solutions are implemented in the first place.

Post-sale systems support is just as effective. Commenco's project management and engineering teams provide a first-level customer interface to ensure that the customer's needs are being met at every step of the system implementation process. Commenco's service shop is the largest in the area providing expert maintenance and service support for years of system use.

## **CURRENT 9-1-1 INSTALLATIONS**

In August, 2001, Commenco was chosen by the Mid-America Regional Council to supply, install, and maintain a new 9-1-1 system for the Kansas City metropolitan area. This system includes nine counties and the public safety dispatch centers listed below.

Mid-America Regional Council  
600 Broadway  
Kansas City MO 64105

Keith Faddis, Public Safety Program Director (816) 474-4200

American Medical Response  
3121 S. Dodgion Street  
Independence MO 64055  
(816) 836-1594

Belton Police Dept.  
7001 E. 163rd Street  
Belton MO 64012  
(816) 331-5522

Blue Springs Police Dept.  
1100 SW Smith  
Blue Springs MO 64015  
(816) 228-0151

Cass County Sheriff  
208 W. Pearl  
Harrisonville MO 64701  
(816) 380-8424

Central Jackson County Fire  
4715 SW US 40 Hwy  
Blue Springs, MO 64015  
(816) 229-9118

Clay County Sheriff  
12 S. Water  
Liberty MO 64068  
(816) 792-7700

Claycomo Police Department  
115 NE 69 Highway  
Claycomo MO 64119  
(816) 452-4613

Fort Leavenworth Provost Marshall  
9-1-1 Communications  
Fort Leavenworth KS 66077  
(913) 684-3537

Gladstone Public Safety  
7010 N. Holmes  
Gladstone MO 64118  
(816) 436-3550

Grandview Police/Fire Dept.  
1200 Main Street  
Grandview MO 64030  
(816) 316-4906

Harrisonville Police Dept.  
P.O. Box 367  
Harrisonville MO 64701  
(816) 380-8929

Leavenworth County Sheriff  
601 S. 3rd Street, Suite 2007  
Leavenworth KS 66048  
(913) 758-4048

Independence Police Dept.  
223 N. Memorial Drive  
Independence MO 64050  
(816) 325-7265

Leavenworth Police Dept.  
601 S. 3rd Street  
Leavenworth KS 66048  
(913) 680-2514

Jackson County Sheriff  
3310 NE Rennau Drive  
Lee's Summit MO 64064  
(816) 524-4302

Leawood Police Dept.  
9617 Lee Blvd.  
Leawood KS 66206  
(913) 339-6700

Johnson County E.C.C.  
6000 Lamar  
Mission KS 66202  
(913) 826-1010

Lee's Summit Fire Dept.  
207 SE Douglas Street  
Lee's Summit MO 64063  
(816) 969-7352

Johnson County Sheriff  
125 N. Cherry Street  
Olathe KS 66061  
(913) 791-5240

Lee's Summit Police Dept.  
10 NE Tudor Road  
Lee's Summit MO 64086  
(816) 969-7463

Kansas City MO Fire Dept.  
1111 Locust, 5th Floor  
Kansas City MO 64106  
(816) 513-0922

Lenexa Police Dept.  
12500 W. 87th Parkway  
Lenexa KS 66215  
(913) 477-7310

Kansas City MO Fire Dept.  
Metropolitan Ambulance Services  
6740 Eastwood Trfwy  
Kansas City MO 64129  
(816) 300-2404

Liberty Police Dept.  
101 E. Kansas  
Liberty MO 64068  
(816) 792-6082

Kansas City MO Police Dept.  
1101 Locust  
Kansas City MO 64106  
(816) 889-6191

Miami County Sheriff  
120 S. Pearl  
Paola, KS 66071  
(913) 294-4444

Kansas City KS / Wyandotte County  
Unified Government 9-1-1  
6730 Riverview Avenue  
Kansas City KS 66102  
(913) 596-3032

North Kansas City Police  
2010 Howell Street  
N. Kansas City MO 64116  
(816) 274-6013

Olathe Police Dept.  
501 E. 56 Highway  
Olathe KS 66061  
(913) 393-6534

Ray County / Richmond 9-1-1  
102 W. North Main Street  
Richmond MO 64085  
(816) 776-2200

Overland Park Police Dept.  
8500 Santa Fe Drive  
Overland Park KS 66212  
(913) 895-6300

Raymore Police Dept.  
210 S. Washington  
Raymore MO 64083  
(816) 331-0530

Platte County Sheriff  
415 Third Street, Suite 10  
Platte City MO 64079  
(816) 858-1965

Raytown Police Dept.  
10000 E. 59th Street  
Raytown MO 64133  
(816) 737-6020

Pleasant Hill Police Dept.  
203 Paul Street  
Pleasant Hill MO 64080  
(816) 540-9109

Riverside Public Safety  
4500 NW High Drive  
Riverside MO 64168  
(816) 741-1191

Pleasant Valley Police Dept.  
6801 Sobbie Road  
Pleasant Valley MO 64068  
(816) 781-7373

Shawnee Police Dept.  
6535 Quivira  
Shawnee KS 66216  
(913) 631-2155

Prairie Village Police Dept.  
7710 Mission Road  
Prairie Village KS 66208  
(913) 385-4620

Sugar Creek Police Dept.  
103 S. Sterling  
Sugar Creek MO 64054  
(816) 252-7058

**Other 911 Systems  
Sold & Installed by Commenco**

Central Missouri State University  
306 Broad Street  
Warrensburg, MO 64093  
(660) 543-4502

Marshall County Sheriff  
107 S. 13<sup>th</sup> Street  
Marysville, KS 66508  
(913)562-3141

Coffey County Sheriff  
605 Neosho Street  
Burlington, KS 66839  
(660) 831-1911

Pettis County 911  
319 South Lamine  
Sedalia, MO 65301  
(660) 827-4800

Gentry County Emergency Dispatch  
202 N. Smith  
Albany, MO 64402  
(660) 726-4234

Russell County 911  
339 East 8<sup>th</sup> Street  
Russell, KS 67665  
(785) 483-2121

Higginsville Police Department  
1922 Main  
Higginsville, MO 64037  
(660) 584-3354

Saline County 9-1-1  
2025 South Odell Ave  
Marhsall, MO 65340  
(660) 831-1911

University of Kansas  
1246 W. Campus Road, #302  
Lawrence, KS 66045  
(785) 864-5900

Western Missouri 9-1-1  
2040 E. Hunter  
Nevada MO 64772  
(417) 667-0200





## Memorandum to County Commission

March 2, 2011

**RE: Attachment of lands in the NE ¼ of the NW ¼ of Section 13-13-20 into Rural Water District #4**

### Background.

A petition was filed in the County Clerks' office by Faye Coleman, the then property owner, for the attachment of her lands in Section 13-13-20 into Rural Water District No. 4. Since the petition was filed, the property has changed ownership and is now owned by Matthew and Rachel Karstetter. It is their desire to proceed with the attachment petition, as they purchased the property with the intent to build a home on it. Because this land is within the Urban Growth Area of Lawrence, a water meter is required for any new residential building. The property is also within 3 miles of the city limits of Eudora.

### Statutory Process and Procedures.

K.S.A. 82a-624. This statute governs the process for attaching new lands to Rural Water Districts. Based on this statute, the following actions are prescribed and have been taken:

- A hearing is required to be held by the County Commission within 30 days of the date of the filing of the petition.
- The County Clerk shall provide written notice, at least 7 days prior to the hearing date, by first class mail of the time and place of the hearing, along with a copy of the petition, to:
  - owners of all lands within the area of the attachment;
  - the office of the Board of Directors of the Rural Water District; and,
  - the Chief Engineer, Division of Water Resources (DWR), Ks State Board of Agriculture

K.S.A. 19-270. This statute requires additional notice be provided when the attachment lands are located within 3 miles of any city that has adopted Subdivision Regulations. The additional notice requirements for the County Clerk are, to provide:

- written notice by first class mail of the time and place of such hearing, along with a copy of the attachment petition, to "any city having territory within 3 miles of any of the land sought to be attached and to such city's planning commission"; and
- Public notice in the official county newspaper, at least 7 days before the hearing, of the hearing date for consideration of the attachment petition.

### County Commission Action:

K.S.A. 82a-624 requires the County Commission:

- make the following findings:
  - whether proper notice has been given as required by said statute; and,
  - whether the statements contained in the petition are true and if a majority of the members of the board of the district to which the attachment is desired do not object to it.

K.S.A. 19-270(b) requires that additional considerations be given when the attachment lands are within 3 miles of a city. These considerations are:

- The Board of County Commissioners shall receive testimony from any city or planning commission having jurisdiction over any of the affected land area. The testimony shall address any incompatibilities between the creation of expansion of the district within such fringe area and any adopted land use or comprehensive plans.

- As a guide in determining the advisability of authorizing the creation of change in boundaries of a district, the Board's considerations shall include:
  - Size and population of the city
  - The city's growth in population, business and industry during the past 10 year
  - Extension of the city's boundaries during the past 10 years
  - The probability of its growth toward the territory during the ensuing 10 years, taking into consideration natural barriers and other reasons which might influence growth toward the territory;
  - The willingness of the city to annex the territory and its ability to provide city services in case of annexation; and,
  - The general effect upon the entire community.
- A  $\frac{3}{4}$  vote of the majority of the County Commission for approval of the attachment of lands.

K-10 Ramp

K-10

K-10

SCHAANK LARRY C TRUSTEES

TWIN OAKS GOLF COMPLEX INC

SPRAY CARL TRUSTEE

COLEMAN ROBERT

S11-T13S-R20E

S12-T13S-R20E

SPRAY MIRIAM L TRUSTEE OF

ERNST PHILIP R

BURCHETT DENNIS L

HOUGHTON JAMES S CO-TRUSTEES

SMITH WILLIAM R JR

SPRAY MIRIAM L TRUSTEE OF

BURCHETT DENNIS L

WAK N DUJ LLC

ALLIANCE RADIOLOGY PC

COLEMAN ROBERT L

WEEKS WILLIAM V

WAK N DUJ LLC

SMITH WILLIAM R JR

COOK AMY L

SELVAN KANDAYA

THOMAS REBECCA

E 1900 Road

N 1275 Road

E 1950 Road

THOMAS SARAH B

NEADERHISER CHARLENE L TRUSTEES

DICKERSON JOHN L

MOPEK HEATHER

KREUTZIGER ROSEMARIE

COOVERT CHRISTOPHER A MURDOCH MURRAY K

MORRISON DAVID C TRUSTEES

TIGNER JOE

S13-T13S-R20E

KEENE FRED

MORRISON DAVID C

WALLACE ROBERT BJR

2" 301

N 1250 Road

MORRISON DAVID C

VANLERBERG ROBERT J

HIGGINS RICHARD W

SELVAN KANDAYA

WARREN ANDREA J TRUSTEES

SOLBERG OLIVER M TRUSTEE

GAEDDERT WILLIAM K

TYLER NORMAN L

MORRISON DAVID C TRUSTEES

FARMER DOROTHY L

STEFFEN SHIRLEY

SOLBERG OLIVER M TRUSTEE

SCHWATKEN RODNEY E TRUSTEE

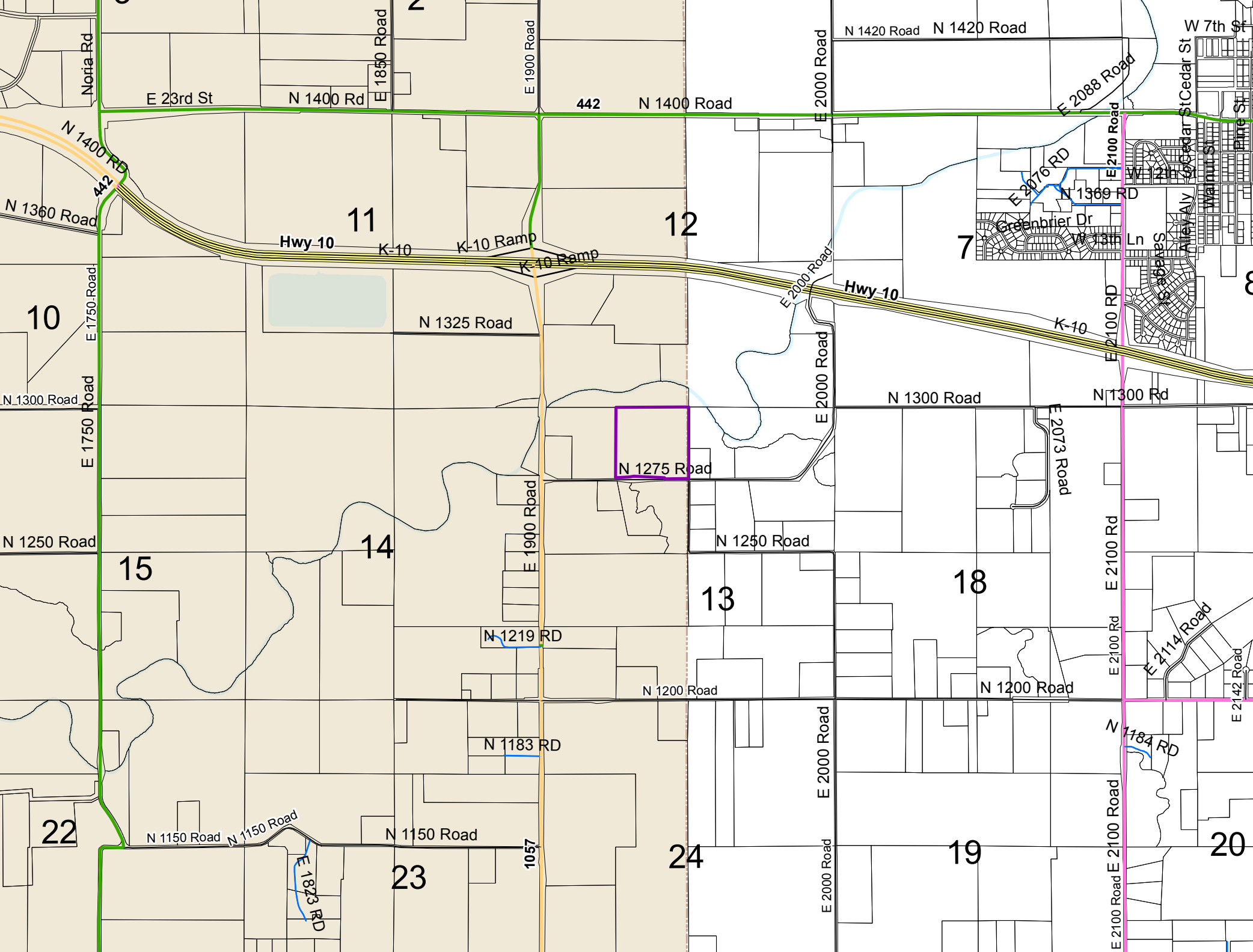

BEFORE THE BOARD OF COUNTY COMMISSIONERS OF DOUGLAS COUNTY, KS

In the Matter of the Petition for  
Attachment of Lands to Rural  
Water District No. 4,  
Douglas County, Kansas

PETITION FOR APPROVAL OF ATTACHMENT OF LANDS  
TO RURAL WATER DISTRICT NO. 4, DOUGLAS COUNTY, KANSAS

TO: THE BOARD OF COUNTY COMMISSIONERS OF DOUGLAS COUNTY, KANSAS

Petitioners, being landowners of Douglas County, Kansas, represent and state as follows:

1. That the undersigned Petitioners are all the owners of certain land within Douglas County and desire the same to be annexed and attached to Rural Water District No. 4; the boundaries of such land are defined by metes and bounds as follows:

*The Northeast Quarter of the Northwest Quarter  
(NE 1/4, NW 1/4) of Section Thirteen (13),  
Township Thirteen (13) South, Range Twenty (20)  
East of the 6<sup>th</sup> Principal Meridian.*

2. That attached hereto is a verification of the enumeration of landowners taken from the tax rolls of Douglas County.
3. That the lands within such boundaries are without an adequate supply of water and can be economically served by the facilities of Rural Water District No. 4, Douglas County, Kansas.
4. That the attachment to Rural Water District No. 4, Douglas County, Kansas of the land contained within the boundaries of the described areas will be conducive to and will promote the public health, convenience, and welfare.
5. That some or all of the land to be attached is within the three-mile fringe area of a city and therefore a 3/4 majority of the Board of County Commissioners must approve the Petition.

WHEREFORE, Petitioners pray that the Board of County Commissioners of Douglas County, Kansas, fix a time and place within thirty (30) days from the date of filing of this

Example of Petition provided as a courtesy of RWD No. 4

Petition for a hearing of the same; that the County Clerk of Douglas County, Kansas, at least seven days before the hearing date, send written notice by first class mail of the time and place of such hearing together with a copy of this Petition, to each of the owners of land within the areas to be attached, to the office of the Board of Directors of Rural Water District No. 4, Douglas County, Kansas, and to the Chief Engineer, Division of Water Resources, State Board of Agriculture [to the City of ~~Lawrence, Baldwin City or Eudora~~, and to the Lawrence/Douglas County Planning Commission]. That the Board of County Commissioners, upon hearing, make appropriate findings and approve the annexation and attachment of such lands to Rural Water District No. 4, Douglas County, Kansas, and thereupon enter upon its records full minutes of such hearing, together with a declaration that henceforth the District shall include the described land in the District, all as provided in K.S.A. §82a-622 to §82a-624 inclusive [and KSA 19-270].

PETITIONERS

Wayne Q. Coleman

---

---

---

---

---

### VERIFICATION OF ENUMERATION

State of Kansas

County of Douglas

FAYE A. COLEMAN, being first duly sworn on oath, deposes and states that he is [one of the landowners of the above described land sought to be attached] ~~[an attorney representing the landowners/petitioners]~~, that an enumeration of the owners of land in the boundaries of the area to be annexed and attached to Rural Water District No. 4 has been taken from the tax rolls of the County, is attached hereto and is true and correct. This verification is provided pursuant to K.S.A. 82a-622.

Faye A. Coleman

Subscribed and sworn to before me this 24<sup>th</sup> day of January, 2011.

Scott D. Schultz  
Notary Public

My Commission Expires: 3/22/14

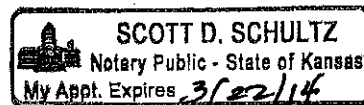

BEFORE THE BOARD OF COUNTY COMMISSIONERS OF DOUGLAS COUNTY, KS

In the Matter of the Petition for  
Attachment of Lands to Rural  
Water District No. 4,  
Douglas County, Kansas

REQUEST FOR PETITION FOR ATTACHMENT OF LANDS TO  
RURAL WATER DISTRICT NO. 4

The following owners of land in areas currently located outside the boundaries of Rural Water District No. 4, Douglas County, Kansas, whose signatures appear below, finding that the supply of water to our land is inadequate; that our land can be economically served by the facilities of Rural Water District No. 4; and that the same will be conducive to and will promote the public health, convenience and welfare, do hereby request that a Petition be prepared, ~~signed on our behalf by~~ our Attorneys, and filed with the County Clerk of Douglas County, seeking the approval of attachment of lands to Rural Water District No. 4, by the Board of County Commissioners of Douglas County, Kansas.

NAME

ADDRESS

Faye A. Coleman  
Sign Name

1328 E 2000 RD, EUDORA, KS 66025

FAYE A. COLEMAN  
Print Name

\_\_\_\_\_  
Sign Name

\_\_\_\_\_  
Print Name

\_\_\_\_\_  
Sign Name

\_\_\_\_\_  
Print Name

Note: 82a-622 permits a Petition to be signed "on behalf of" landowners, when the Petition is accompanied by a request for petitioning signed by at least 50% of the owners of land within the area. This form could be used for that purpose.





# Douglas County Kansas Access

## LAND RECORDS APPLICATION

This application accesses the web-based Real Estate and CAMA systems. To view the different CAMA and Real Estate views, please select an option from the 'Select View' menu on the top-right of your screen. This information is assumed valid as of: 1/19/2011.

### REAL ESTATE VIEW

[New Search](#) | [Modify Search](#) | [Search Results](#) | [Printer-friendly Version](#)



- Select Year -    - Select View -

PROPERTY INFORMATION			
Year: 2010	PIN Number: 023-106-13-0-00-00-003.00-0	Plate Number: 200093A	
Owner 1: COLEMAN FAYE A			
Owner 2: <no record>			
In-Care-Of: <no record>			
Property Address: , EUDORA TWP, KS			
Mailing Address: 1328 E 2000 RD, EUDORA, KS 66025			
Delinquent Tax: No	Tax Unit: 619	School: USD 491	Loan Number:
Sec-Twp-Rng: 13-13-20	Book: 1051	Page: 3491	Deed: 01/01/2010 *

(\*click on the above deed date to link to the Deed system)

VALUE INFORMATION						
Class	Appraised			Assessed		
	Land	Improvements	Total*	Land	Improvements	Total
AR	\$2,390	\$0	\$2,390	\$717	\$0	\$717

TAX INFORMATION					
Tax: \$93.88	Special Tax: \$0.00	Total Tax: \$93.88	Taxes Paid: \$93.88	Mill Levy: 130.9230	

TAX PAYMENT INFORMATION				
Year	Payment Date	Payment Type	Payment Amount	
2010	12/13/2010	PAYMENT	\$93.88	

DESCRIPTION
13-13-20 NE/4 NW/4 LESS R/W 38.4A( C)

LEGAL INFORMATIOND
40A 13-13-20 NE 1/4 NW 1/4 WW35

GUARANTEE LAND TITLE OF LEAVENWORTH, INC.

400 DELAWARE, LEAVENWORTH, KS 672 0200

2071

CORPORATION DTD GENERAL WARRANTY DEED

THIS DEED MADE THIS 18th day of March 1987 by and between MUTUAL SAVINGS ASSOCIATION

of the County of Leavenworth, State of Kansas, and FAYE A. CAENEN, of the County of Leavenworth, State of Kansas, for and in behalf of the Mutual Savings Association, a corporation duly organized and existing under the laws of the State of Kansas, do hereby certify that the above described premises are the property of the Mutual Savings Association, a corporation duly organized and existing under the laws of the State of Kansas, and that the same are being conveyed to the said FAYE A. CAENEN and FAYE A. CAENEN, her heirs and assigns forever.

TO HAVE AND TO HOLD the above premises together with all and singular the tenements, hereditaments and appurtenances thereto in anywise appertaining, unto the said FAYE A. CAENEN and FAYE A. CAENEN, her heirs and assigns forever, as joint tenants, the survivor to take the whole estate.

WITNESSETH that the above premises are the property of the Mutual Savings Association, a corporation duly organized and existing under the laws of the State of Kansas, and that the same are being conveyed to the said FAYE A. CAENEN and FAYE A. CAENEN, her heirs and assigns forever.

And Other Good & Valuable Consideration for the receipt of which is hereby acknowledged by the above parties, and without note and mortgage and with the right of survivorship and the right of the said FAYE A. CAENEN and FAYE A. CAENEN, her heirs and assigns forever to take the whole estate situated in the County of Leavenworth, State of Kansas.

The Northwest Quarter of the Northwest Quarter 138E 174, 18W 1741 of Section Thirteen (13), Township Thirteen (13) South, Range Twenty (20) East of the 6th Principal Meridian.

(SUBJECT TO RESTRICTIONS, RESERVATIONS, EASEMENTS OR BURDENS, IF ANY)

TO HAVE AND TO HOLD THE SAME, together with all and singular the tenements, hereditaments and appurtenances thereto belonging or in anywise appertaining, forever, as joint tenants, the survivor to take the whole estate.

And said party for itself, its successors and assigns, does hereby covenant, promise and agree to and with said second parties that at the delivery of these presents it is lawfully seized in its own right of an absolute and indefeasible estate of inheritance, in fee simple, or and in all and singular the above-granted and described real estate, with the appurtenances, that the same are free, clear, discharged and unincumbered of and from all former and other grants, titles, charges, estates, judgments, taxes, assessments and incumbrances, of what nature or kind soever, except

and that it will warrant and forever defend the same unto said second parties, as joint tenants with the right of survivorship and not as tenants in common, against said first party, its successors and assigns, and all and every person or persons whomsoever lawfully claiming or to claim the same.

IN WITNESS WHEREOF, said first party has caused this deed to be signed on its behalf by its President, thereunto duly authorized so to do and has caused its corporate seal to be hereunto affixed on the day and year first above written.



MUTUAL SAVINGS ASSOCIATION  
By Donald E. Biggs  
DONALD E. BIGGS, President.

STATE OF KANSAS LEAVENWORTH COUNTY, ss.

BE IT REMEMBERED, That on this 18th day of March 19 87 before me, the undersigned, a Notary Public in and for the County and State aforesaid, came Donald E. Biggs President of Mutual Savings Association a corporation duly organized, incorporated and existing under and by virtue of the laws of KANSAS, who is personally known to me to be such officer, and who is personally known to me to be the same person who executed, as such officer, the foregoing deed on behalf of said corporation, and such person duly acknowledged the execution of the same to be the act and deed of said corporation.

(SEAL)

IN TESTIMONY WHEREOF, I have hereunto subscribed my name and affixed my official Seal the day and year last above mentioned.

MARY F. CAENEN  
NOTARY PUBLIC Mary F. Caenen Notary Public  
Leavenworth County, Kansas Term Expires July 30 19 87  
My Appointment Expires 7-31-87

Kansas Department of Health and Environment  
Office of Vital Statistics  
**CERTIFICATE OF DEATH**

115-2009-03331

State File Number

1. Decedent's Legal Name (First, Middle, Last) <b>ROBERT LEE COLEMAN</b>		2. Sex <b>MALE</b>	3. Date Of Death (Month, Day, Year) <b>02/17/2009</b>	4. Social Security Number [REDACTED]	5. Date Filed By State Registrar: <b>03/02/2009</b>
6a. Date Of Birth (Month, Day, Year) <b>02/17/1936</b>	6b. Age <b>73 YEAR(S)</b>	7. Place Of Birth (City And State Or Foreign Country) <b>PERRY, KANSAS</b>		8. Decedent Ever In U.S. Armed Forces <b>NO</b>	
9a. Place Of Death <b>INPATIENT</b>		9b. Facility Name (If Not Institution, Street And Number) <b>LAWRENCE MEMORIAL HOSPITAL</b>		9c. City Or Town Of Death <b>LAWRENCE</b>	9d. Zip Code <b>66044</b>
9e. County Of Death <b>DOUGLAS</b>	10. Marital Status <b>MARRIED</b>	11. Surviving Spouse (If Wife, Name Before First Marriage) <b>FAYE A STEWART</b>		12a. Residence State or Foreign Country <b>KANSAS</b>	
12b. County or Province <b>DOUGLAS</b>	12c. City Or Town <b>EUDORA</b>	12d. Street Address <b>1328 E 2000 RD</b>		12e. Zip Code <b>66025</b>	12f. Inside City Limits <b>NO</b>
13. Decedent's Ancestry <b>AMERICAN</b>		14. Decedent's Race <b>WHITE</b>			
15. Decedent's Hispanic Origin <b>NOT SPANISH, HISPANIC, LATINO</b>					
16. Decedent's Education <b>HIGH SCHOOL GRADUATE OR GED COMPLETED</b>		17. Decedent's Occupation <b>FIREFIGHTER</b>		18. Decedent's Industry <b>MUNICIPALITY</b>	
19. Father's Name (First, Middle, Last) <b>MAURICE COLEMAN</b>			20. Mother's Name Prior To First Marriage (First, Middle, Last) [REDACTED]		
21a. Informant's Name (First, Middle, Last) <b>FAYE A COLEMAN</b>		21b. Mailing Address (Street, Number, City, State, And Zip Code) <b>1328 E 2000 RD, EUDORA, KANSAS, 66025</b>		21c. Relationship To Decedent <b>WIFE</b>	
22. Method Of Disposition <b>CREMATION</b>		23a. Place Of Disposition <b>RUMSEY-YOST CREMATORY</b>		23b. Location <b>LAWRENCE, KANSAS</b>	
24. Funeral Service Licensee And License Number <b>/s/ BARTON J YOST - 2377</b>			25. Name Of Embalmer And License Number <b>NOT EMBALMED - 9999</b>		
26. Name And Address Of Firm <b>RUMSEY-YOST FUNERAL HOME AND CREMATORY, 601 INDIANA PO BOX 1260, LAWRENCE, KANSAS, 66044</b>					
27. Cause Of Death <i>Part I. Events (diseases, injuries, or complications) that directly caused the death.</i>  IMMEDIATE CAUSE (Final Disease Or Condition Resulting In Death) <b>a. SEPTIC SHOCK</b> Due To (Or As A Consequence Of): <b>b. GASTRIC AND DUODENAL INFARCTION</b> Due To (Or As A Consequence Of): <b>c.</b> Due To (Or As A Consequence Of): <b>d.</b> Due To (Or As A Consequence Of):					Approximate Interval: Onset To Death <b>DAYS - 3</b> <b>3 DAYS</b>
<i>Part II. Other Significant Conditions Contributing To Death But Not Resulting In The Underlying Cause Given In Part I.</i> <b>AAA REPAIR 2 YEARS PRIOR 4/07</b>		28a. Autopsy <b>YES</b>	28b. Autopsy Findings Available To Complete The Cause Of Death <b>YES</b>	28c. Coroner Contacted <b>YES</b>	
29. Did Tobacco Use Contribute To Death? <b>PROBABLY</b>		30. If Female:		31. Manner Of Death <b>NATURAL</b>	
32a. Date Of Injury (Month, Day, Year)	32b. Time Of Injury	32c. Injury At Work	32d. How Injury Occurred		
32e. Place Of Injury		32f. Location (Street And Number Or Rural Route, City Or Town, State, And Zip Code)			
33a. Date Pronounced Dead (Month, Day, Year) <b>02/17/2009</b>	33b. Time Pronounced Dead <b>5:50 PM</b>	33c. Actual Or Presumed Time Of Death <b>5:50 PM</b>	33d. Name Of Person Pronouncing Death <b>VANCE R BURNS MD</b>		33e. License No.
34a. Pronouncing and Certifying Physician <b>/s/ VANCE BURNS - MD</b>		34b. License No. <b>429900</b>	34c. Date Certified (Month, Day, Year)	34d. Address And Zip Code Of Person Completing Cause Of Death <b>325 MAINE ST, LAWRENCE, KANSAS, 66047</b>	

VS231A - Rev. 06/18/2004

Death 3/2/2009 V220021807 02 COLEMAN 200904003331 20c @@ Courier @@



This is a true and correct copy of the official record on file in the Office of Vital Statistics, Topeka, Kansas, certified on the date stamped below.

2009 MAR -2 PM 0:40

*Elizabeth W. Saadi*

Elizabeth W. Saadi, Ph.D.  
Acting State Registrar  
Office of Vital Statistics  
Department of Health & Environment

A04406398

It is in violation of KSA 65-2422d(g) to "prepare or issue any certificate which purports to be an original, certified copy or copy of a certificate of birth, death or fetal death, except as authorized in this act or rules and regulations adopted under this act."

**CERTIFIED COPIES WILL BE PRODUCED ON MULTI-COLOR SECURITY PAPER.**



Douglas County Register of Deeds  
Book: 1051 Page: 3491

Receipt #: 397311  
Pages Recorded: 2  
Cashier Initials: rec

Recording Fee: \$12.00  
Authorized By: *Lay Penell*

Date Recorded: 7/7/2009 11:39:07 AM



**NOTICE TO PUBLISHER:**

**Publish one time at least seven (7) days prior to the date of the hearing.**

**BEFORE THE BOARD OF COUNTY COMMISSIONERS**  
**OF DOUGLAS COUNTY, KANSAS**

In the Matter of the Petition for  
Attachment of Lands to Rural Water District No. 4,  
Douglas County, Kansas

**NOTICE OF HEARING ON PETITION FOR ATTACHMENT OF LANDS**  
**TO RURAL WATER DISTRICT NO. 4, DOUGLAS COUNTY, KANSAS**

To All Persons Concerned:

You are hereby notified that a Petition addressed to the Board of County Commissioners of Douglas County, Kansas, has been filed with the County Clerk of Douglas County, Kansas, praying for attachment to existing Rural Water District No. 4, of the tract of land in Douglas County, Kansas, owned by the Petitioner and described as: The Northeast Quarter of the Northwest Quarter (NE 1/4, NW 1/4) of Section Thirteen (13), Township Thirteen (13) South, Range Twenty (20) East of the 6<sup>th</sup> Principal Meridian, all in Douglas County, Kansas consisting of 40 acres more or less.

You are further notified under the authority of K.S.A. 82a-622 through 82a-624 inclusive, and K.S.A. 19-270, that the Petition for Attachment of Lands to Rural Water District No. 4, Douglas County, Kansas will be heard by the Board of County Commissioners, Douglas County, Kansas, on the **2<sup>nd</sup> day of March, 2011, at 6:35 p.m.**, on the Second Floor of the Douglas County Courthouse, 1100 Massachusetts Street, Lawrence, Kansas. Any interested person may present testimony before the Board.

Jameson D Shew, Douglas County Clerk  
1100 Massachusetts St.  
Lawrence, Kansas 66044



## City Of Eudora, Kansas

City Administrator

### Memo

**Date:** February 16, 2011  
**To:** Craig Weinaug, County Administrator  
**From:** John D. Harrenstein, City Administrator *J.H.*  
**Re:** Petition for attachment of lands to Douglas County Rural Water District #4

#### Background

Thank you for making the city of Eudora aware of the petition for attachment of lands to Douglas County Rural Water District #4 (RWD4). The property requested by the petition is located on North 1275 road east of 1900 road and less than a mile from the western boundary of the city of Eudora. The purpose of this memo is to express the city of Eudora's adamant opposition to this petition of attachment to RWD4.

#### Opposition to *any* attachment of lands to RWD4

1. The City of Eudora adamantly opposes any attachment of land to RWD4 and encourages the Douglas County Commission to *deny the petition*.
2. The City of Eudora requests the Douglas County Commission convene a discussion with the goal of resolving the present problems of municipal annexations into RWD4's service territory and develop a local process for municipal annexations into Rural Water District service territory.
3. The City of Eudora requests that the Douglas County Commission issue a moratorium on all petitions of attachment of lands to RWD4 until a resolution is made regarding municipal annexations of RWD4 service territory.

#### Explanation of opposition

It is well known that the city of Eudora and RWD4 are engaged in costly and on-going litigation regarding the right to serve development within the boundaries of the city of Eudora that are also within the boundaries of RWD4. Several years ago property was attached to RWD4 near the boundaries of Eudora which ultimately led to the litigation that has cost the city of Eudora over \$600,000 and accrued legal fees for RWD4 of approximately \$900,000. Clearly, the present situation is not working and customers of either the city of Eudora or RWD4 will ultimately pay the cost of this litigation.

Any expansion of land to RWD4 within the three mile growth boundary of Eudora is perceived by the City Council as dangerous and potentially costly to future citizens. For the property under question in our current litigation, RWD4 requested 6.5 million dollars for 153 acres of property that at some time in the future may service 383 residences or businesses. This is a cost of \$16,971 per meter and a price that is not reasonable or in the interest of citizens. Further, the intractable nature of the RWD4 organization on negotiating a reasonable price for their service territory according to Kansas law has slowed development and economic growth for both the City of Eudora and Douglas County. Claiming Federal protection of service territory, RWD4 is holding ransom the future of southern growth in Eudora.

#### Summary

The present petition for attachment of lands to RWD4 raises serious public policy issues of importance to both the Douglas County Commission and the city of Eudora. No longer can we risk the prolonged and costly litigation that stems from an attachment of land to RWD4 several years ago that now has a combined cost of over 1.5 million dollars. Any attachment of land risks the same costs until a resolution to municipal annexation of RWD4 service territory is achieved. The City Council of Eudora strongly urges denial of this petition.

**Residential Anti-displacement and Relocation Assistance Plan  
under Section 104(d) of the  
Housing and Community Development Act of 1974, as Amended**

The County of Douglas, KS will replace all occupied and vacant occupiable low- and moderate-income dwelling units demolished or converted to a use other than as low- and moderate-income housing as a direct result of activities assisted with funds provided under the Housing and Community Development Act of 1974, as amended, as described in 24 CFR Part 570.488.

All replacement housing will be provided within three years of the commencement of the demolition or rehabilitation relating to conversion. Before obligating or expending funds that will directly result in such demolition or conversion, the County of Douglas, KS will make public and submit to the Kansas Department of Commerce the following information in writing:

1. A description of the proposed assisted activity;
2. The general location on a map and approximate number of dwelling units by size (number of bedrooms) that will be demolished or converted to a use other than as low- and moderate-income dwelling units as a direct result of the assisted activity;
3. A time schedule for the commencement and completion of the demolition or conversion;
4. The general location on a map and approximate number of dwelling units by size (number of bedrooms) that will be provided as Section 104(d) replacement dwelling units;
5. The source of funding and a time schedule for the provision of Section 104(d) replacement dwelling units; and
6. The basis for concluding that each Section 104(d) replacement dwelling unit will remain a low- and moderate-income dwelling unit for at least 10 years from the date of initial occupancy.

The County of Douglas will provide relocation assistance, as described in Section 570.488 to each low- and moderate-income household displaced by the demolition of housing or by the conversion of a low- and moderate-income dwelling to another use as a direct result of assisted activities.

Consistent with the goals and objectives of activities assisted under the act, the County of Douglas will take the following steps to minimize the displacement of persons from their homes:

Based on initial review of project, the following occupied dwellings (by address) will be demolished with grant funds:

This project will not contain demolition.

As chief elected official of County of Douglas, I hereby certify that the above plan was officially adopted by County of Douglas on the 2nd day of March, 2011.

\_\_\_\_\_  
Date

\_\_\_\_\_  
Signature - Chief Elected Official

**Instructions in General Application Requirements or Grantee Handbook**

**Applicant/Recipient Information**

Indicate whether this is an Initial Report  or an Update Report

1. Applicant/Recipient Name, Address, and Phone (include area code): Douglas County  ( ) -	2. Social Security Number or Employer ID Number:  - -
3. CDBG Grant Number:	4. Amount of HUD Assistance Requested/Received
5. State the name and location (street address, City and State) of the project or activity:	

**Part I Threshold Determinations**

1. Are you applying for assistance for a specific project or activity?  <input type="checkbox"/> Yes <input type="checkbox"/> No	2. Have you received or do you expect to receive assistance, involving the project or activity in this application, in excess of \$200,000 during this fiscal year.  <input type="checkbox"/> Yes <input type="checkbox"/> No.
--	--

If you answered "No" to either question 1 or 2, **Stop!** You do not need to complete the remainder of this form. **However**, you must sign the certification at the end of the report.

**Part II Other Government Assistance Provided or Requested / Expected Sources and Use of Funds.**

Such assistance includes, but is not limited to, any grant, loan, subsidy, guarantee, insurance, payment, credit, or tax benefit.

Department/State/Local Agency Name and Address	Type of Assistance	Amount Requested/Provided	Expected Uses of the Funds

(Note: Use Additional pages if necessary.)

**Part III Interested Parties.** You must disclose:

- All developers, contractors, or consultants involved in the application for the assistance or in the planning, development, or implementation of the project or activity and
- any other person who has a financial interest in the project or activity for which the assistance is sought that exceeds \$50,000 or 10 percent of the assistance (whichever is lower).

Alphabetical list of all persons with a reportable financial interest in the project or activity (For individuals, give the last name first)	Social Security No. or Employee ID No.	Type of Participation in Project/Activity	Financial Interest in Project/Activity (\$ and %)

(Note: Use Additional pages if necessary.)

**Certification**

**Warning:** If you knowingly make a false statement on this form, you may be subject to civil or criminal penalties under Section 1001 of Title 18 of the United States Code. In addition, any person who knowingly and materially violates any required disclosures of information, including intentional non-disclosure, is subject to civil money penalty not to exceed \$10,000 for each violation.

I certify that this information is true and complete.

Signature:	Date: (mm/dd/yyyy)
X	



THE CITY/COUNTY OF Douglas, KANSAS

RESOLUTION NO. \_\_\_\_\_

RESOLUTION CERTIFYING LEGAL AUTHORITY  
TO APPLY FOR THE 2010 KANSAS  
SMALL CITIES COMMUNITY DEVELOPMENT BLOCK GRANT PROGRAM  
FROM THE KANSAS DEPARTMENT OF COMMERCE  
AND AUTHORIZING THE MAYOR  
TO SIGN AND SUBMIT SUCH AN APPLICATION

WHEREAS, The City/County of Douglas, Kansas, is a legal governmental entity as provided by the laws of the STATE OF KANSAS, and

WHEREAS, The City/County of Douglas, Kansas, intends to submit an application for assistance from the 2010 COMMUNITY DEVELOPMENT BLOCK GRANT PROGRAM.

THE APPLICANT hereby certifies that the City/County of Douglas, Kansas, is a legal governmental entity under the status of the laws of the STATE OF KANSAS and thereby has the authority to apply for assistance from the 2010 KANSAS SMALL CITIES COMMUNITY DEVELOPMENT BLOCK GRANT PROGRAM.

THE APPLICANT hereby authorizes the MAYOR/COMMISSIONER of Douglas County, Kansas, to act as the applicant's official representative in signing and submitting an application for the assistance to the 2010 COMMUNITY DEVELOPMENT BLOCK GRANT PROGRAM.

THE APPLICANT hereby dedicates \$431,300 in cash funds toward this project and \$-0- in in-kind material and/or labor for same.

APPROVED BY THE GOVERNING BODY OF THE CITY/COUNTY OF Douglas, KANSAS, this 2<sup>nd</sup> day of March, 2011.

APPROVED \_\_\_\_\_  
MAYOR/COMMISSIONER

ATTEST \_\_\_\_\_

(SEAL)